

MASSEY UNIVERSITY AVIATION CENTRE
47 Airport Drive, Milson, Palmerston North

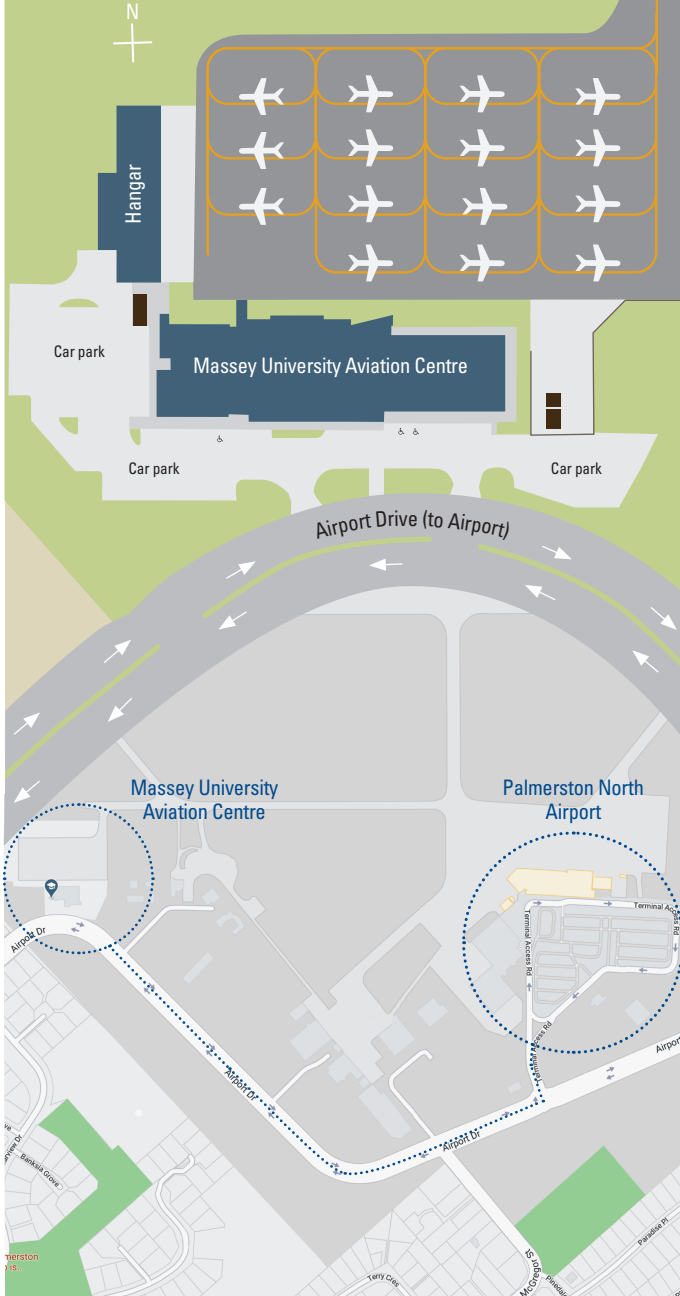

Be prepared to STOP even if you have the right of way.



Maximum speed on campus roads.



You must NOT enter this road.



No stopping, day or night.

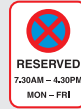

No parking during times indicated. Space is reserved. Your vehicle will be towed.



No Parking. Bus Stop Only.



Pedestrians.



Cycle Lane.



Mobility Card holders only. Card must be displayed.



Pick Up / Drop Off only. Parking for a maximum of 5 minutes.



Pedestrian crossing. Be prepared to stop for people crossing.



Absolutely No stopping day or night (broken yellow line close to kerb).



No Motorcycles / No bicycles / No dogs

Manawatū Campus Map



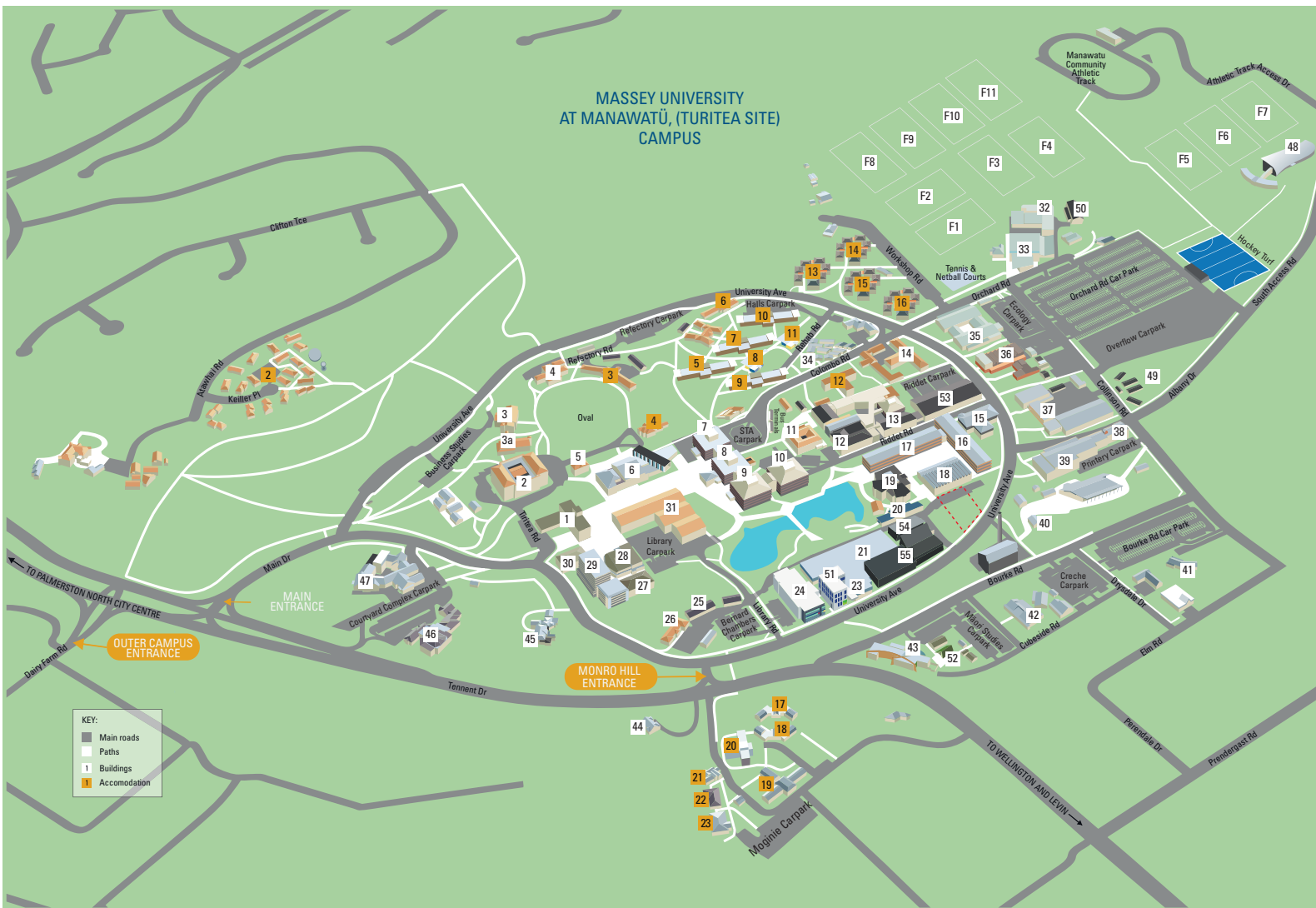

Directory

1	Registry	
2	Sir Geoffrey Peren Building	SGP
3	Business Studies Central	BSW
3a	Business Studies West	BSC
4	Refectory	
5	External Relations	
6	Student Centre	
7	Science Tower A	SCA
8	Science Tower B	SCB
9	Science Tower C	SCC
10	Science Tower D	SCD
11	Information Technology Services	
12	Riddet Complex	RCA, RCB, RCC
13	Food Pilot Plant	
14	Facilities Management	
15	Landcare Research	
16	Aghort Building B	AHB
17	Aghort Building A	AHA
18	Aghort Building C	AHC
19	Aghort Lecture Block	AH
20	Vet Farm Services	
21	School of Veterinary Science	
23	Vet Clinic	
24	Hopkirk Research Institute	
25	Psychology Unit	
26	Bernard Chambers	
27	Psychology Building	PLB
28	Social Sciences Lecture Block	SSLB
29	Social Sciences Tower	SST
30	Geography Building	GLB
31	Library	
32	Events Centre	
33	Recreation Centre	
34	Colombo Village	
35	Riddet Institute – Ecology Building	
36	Wool Building	WB
37	Practical Teaching Complex	PTC
38	Institute of Education	
39	Printery	
40	Equine Treadmill	
41	Kohanga Reo	
42	Childcare Centre	
43	Te Pūtahi-a-Toi School of Māori Studies	MS
44	Elliot House	
45	Wharerata	
46	University House	
47	Courtyard Complex	
48	Sport and Rugby Institute	
49	Collinson Village	
50	Teaching Gym	
51	Veterinary Science	
52	Wharekai	
53	Riddet Institute – Te Ohu Rangahau Kai (TORK)	
54	Pathology Suite	
55	Tawharau Ora	

Accommodation

2	Atawhai	13	Rotary Court
3	McHardy Hall	14	Kairanga Court
4	Turitea House	15	Egmont Court
5	Miro Hall	16	City Court
6	Kiwitea Hall	17	Ruahine Units
7	Totara Hall	18	Tararua Units
8	Karaka	19	Moginie Hall
9	Tawa Hall	20	Walter Dyer Hall
10	Matai Hall	21	Craiglockhart
11	Kanuka	22	Monro Commons
12	Colombo Hall	23	Bindaloe

 [FACEBOOK.COM/MASSEYUNIVERSITY](https://facebook.com/masseyuniversity)

 [TWITTER @MASSEYUNI](https://twitter.com/masseyuni)

 [LINKEDIN.COM/COMPANY/MASSEY-UNIVERSITY](https://linkedin.com/company/massey-university)

 [INSTAGRAM @MASSEYUNI](https://instagram.com/masseyuni)

 [YOUTUBE.COM/MASSEYUNIVERSITY](https://youtube.com/masseyuniversity)

[MASSEY.AC.NZ](https://massey.ac.nz)





Directory

See overleaf for General (continued), Halls of Residence, Research Centres, University House (University House) E6
 Massey University Aviation Centre 47 Airport Drive, Milson, PN
 Office of Vice-Chancellor (Registry: L3) E8
 Office of DVC University Services (Registry: L3) E8
 Office of Provost (Courtyard Complex) E6
 Office of DVC Māori and Pasifika (Te Putahi-a-Toi) G9

General

Academic Dress Hire	D9
Accommodation Services	D10
After-School Care (Massey Kids' Club)	D12
Alumni Relations - Office (Tiritea House)	D8
AgHort Lecture Block and Sciences Building	F10
Archives (PTC)	F11
Aston Lecture Theatres I and II (Science Tower B: L1)	E9
Bernard Chambers A/B/C/D	F8
Boiler House	G10
Campus Books (Student Centre)	E8
Campus Information (Enquiries) (Registry: L2)	E8
Careers Office (Registry: L2)	E8
Centre for Learner Success (Student Centre)	E8
Centre for Professional and Continuing Education (PaCE) (Social Science Tower: L6)	F7
Chaplaincy (The Centre, Waiora)	E9
Child Care Centre	G10
Business Studies West/Central	D8
Concourse	E8
Conference Services (Courtyard Complex)	E6
Corporate Communications (Colombo Village)	D10
Corporate Events (Colombo Village)	D10
Courtyard Complex	E6
DairyNZ	F10
Design Studio (Printery Building: L2)	F11
Dining Hall (Student Centre)	E8
Disability Services (Student Centre)	E8
Ecology Building	D11
Equine Veterinary Clinic	G11
Equity and Ethics (Courtyard Complex)	E6
Events Centre	D12
Facilities Management Manawātū (FMM)	E10
Finance and Asset Management (Registry: L5 and BCA and D)	E8
Fale Pasifika	D9
Geography Building	E7
Governance and Assurance (Registry: L3)	E8
Graduate Research School (Courtyard Complex)	E6
Grounds	C11
Heritage House	E7
Information Technology Services	E9
International Affairs (Social Science Tower: L6)	F7
International Community Centre (YFC)	D9

Islamic Prayer Centre	F9
Kainga Rua (YFC)	D9
Kōhanga Reo	H11
Landcare Research	F10
Library (Main Entrance: L1)	E8
McHardy Hall	D8
Mail Room (PTC)	F11
Māori Visual Arts Workshops (Boiler House Workshop)	G10
Marsden Lecture Theatre (Science Tower B: L1)	E9
Massey Farms and Horticultural Units (DCRU) at No.4 Dairy	D10
Massey Halls Customer Services	D10
Massey University Foundation (Tiritea House)	D8
Medical Centre (MUMC) (Registry: L1)	E8
Medical Assurance Society	F11
Multi Teaching Laboratory Complex (AgHort Building C)	F11
MUSA (Student Centre)	E8
New Zealand Veterinary Association (NZVA - Veterinary Services)	F11
Nursing Studies (Science Tower B:L1)	E9
Orbit Travel (Student Centre)	E8
Parenting Rooms	E8
Pathology Suite	F9
Payroll	D7
People and Culture (formerly POD)	D7
Police (Colombo Road)	E10
Practical Teaching Complex (PTC)	F11
Printery (Printery Building: L1)	F11
Psychology Building	F8
Psychology Clinic (Bernard Chambers B)	F8
Radio Massey (99.4FM) (Student Centre)	E8
Recreation and Sports Centre	D12
Registry	E8
Refractory	D8
Research and Enterprise (Courtyard Complex)	E6
Residential Services Admin. Office	D10
Residential Community Centre (YFC)	D9
Riddet Complex	E10
Riddet Institute	E11
Sciences Towers A/B/C/D	E9
Sir Geoffrey Peren Building	D7
Social Sciences Lecture Block	E8
Social Sciences Tower	F7
Sports Fields	C12
Student Administration (Exec) (Heritage House)	E7
Student Centre	E8
MUSA, Cafeteria, Campus Books, Orbit	E8
MUSA Shop, Student Enterprise, Investment Room	E8
Student Counselling (Registry: L1)	E8
Student Mobility (Social Science Tower: L6)	F7
Student Notes Distribution Centre (SNDC) (Printery Building: L1)	F11
Tawharau Ora (Student Learning Complex)	G9
Te Atahai Manawatahi	D9
Te Hoe Nuku Roa	G9

Te Ohu Rangahau Kai	E10
Te Pūmanawa Hauora	G9
Te Rau Tauawhi (Māori Student Centre)	E8
TEU	F11
Tiritea House (Alumni Relations Office)	D8
Security and Traffic (Colombo Road)	E10
Vet Clinic and Small Animal Reception	G9
Veterinary Teaching Hospital	F9
Equine and Farm Services Reception	F10
Veterinary Science Building	G9
Wharerata	F7
White House	D12
Wool Building	E11

Massey Business School

MBA Office (Business Studies West: L3)	D8
School of Accountancy (Business Studies West)	F7
School of Communication, Journalism and Marketing (Business Studies Central)	F7
School of Economics and Finance, Manawātū and Wellington (Business Studies West)	D8
School of Management Manawātū and Wellington (Business Studies Central)	D8
School of Aviation (47 Airport Drive, Milson)	D8
Office of the Pro Vice-Chancellor (Old Registry)	D8

College of Health

Office of Pro Vice Chancellor (Social Science Tower: L8)	F7
School of Health Sciences (Social Sciences Tower: L7)	F7
School of Nursing (Social Science Tower L8)	F7
School of Social Work (Social Sciences Tower: L7)	F7
School of Sport, Exercise and Nutrition (PTC)	F11

College of Humanities and Social Sciences

Institute of Education (Social Science Tower: L4)	F1
Office of the Pro Vice-Chancellor (Sir Geoffrey Peren)	F7
School of English and Media Studies (Sir Geoffrey Peren)	D7
School of Humanities (Sir Geoffrey Peren)	D7
School of Māori Studies (Te Pūhaki-a-Toi) (Tennent Drive Monro Hill)	G9
School of People, Environment and Planning SST: L2	E7
School of Psychology (Psychology Building)	F8
Centre for Defence Studies (SST L5)	F7
Research Centre for Māori Health and Development (Research Building 2, Bourke Rd)	G9

College of Sciences

Office of the Pro Vice-Chancellor (Science Tower B: L2)	E9
School of Agriculture and Environment (AgHort Building B: L2)	E10
School of Food and Advanced Technology (Riddet Complex)	E10
School of Natural Sciences (Science Tower B: L3)	E9
School of Veterinary Science (Vet Science Building)	G9